

E P35E - 15k Series-2 Choke

15 000 psig / Max Cv 129 / Max Bean Size 179

VALVE SPECIFICATIONS

This choke valve uses a bolted bonnet to retain the flow trim in the valve body. The flow trim is pressure balanced to minimize the stem loads and provide low operating torques. Standard end connections range in size from 3" to 4".

Valve Model	P35E
Body Type	Right Angle
Body Rating	15 000 PSIG (Maximum C.W.P.)
Inlet Connection	see 'Standard End Connections'
Outlet Connection	see 'Standard End Connections'
Bonnet Type	Bolted
Body / Bonnet Material	see 'Material Options'
Stem Material	see 'Material Options'
Seal Material	see 'Material Options'
Trim Style	Ported Cage with External Sleeve
Balanced / Unbalanced	Balanced
Flow Characteristic	Equal Percentage
Trim Material	see 'Trim Options'
Design Cv	see 'Trim Options'
Leakage Class	Class V (Standard)



TRIM OPTIONS

	Standard Trim Cage & External Sleeve 2 Row / 4 Hole
Material	Tungsten Carbide
Application	Liquid, Gas, Multiphase; Abrasive
Cv	129
Turns	16
Travel	2.65"

STANDARD END CONNECTIONS

Connection Size ▶	Standard Dimensions & Estimated Weights											
	3" Nominal						4" Nominal					
	Inlet 'I'		Outlet 'O'		Weight		Inlet 'I'		Outlet 'O'		Weight	
Connection Type ▼	inch	mm	inch	mm	lbs.	kg	inch	mm	inch	mm	lbs.	kg
15 000 API 6BX Studded x Studded	6.50	165	8.75	222	750	341	7.12	181	9.25	235	1060	481
15 000 IPA GBX Studded x Flange	6.50	165	11.00	279	715	325	7.12	181	15.25	387	1185	538

ENVELOPE DIMENSIONS

Dimensions 'A', 'B', and 'C' apply to manually operated chokes and are tabulated below. 'I' (inlet) and 'O' (outlet) dimensions depend on the end connections and are tabulated above. Special dimensions and other end connections are available upon request.

Dimensions		
	inch	mm
A	22.69	576
B	28.00	711
C	32.25	819

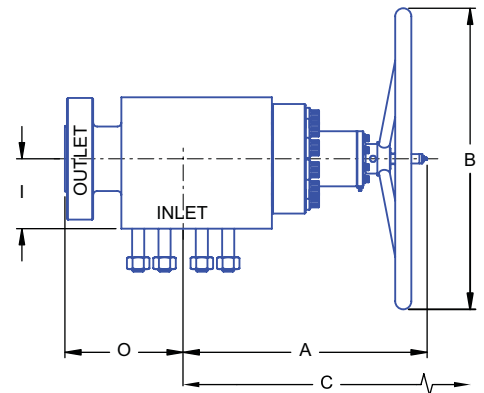

Note: "C" is the disassembly clearance.

MATERIAL OPTIONS

Temperature Class	Certification Level	API - 6A Material Class Designations					
		AA	BB	CC	DD	EE	FF
PU -20F to 250F	STD / PSL-1	EE	EE	FF	EE	EE	FF
PX* -20F to 350F	PSL-2	EE	EE	FF	EE	EE	FF
	PSL-3	EE	EE	FF	EE	EE	FF
LU -50F to 250F	STD / PSL-1	EE	EE	FF	EE	EE	FF
LX* -50F to 350F	PSL-2	EE	EE	FF	EE	EE	FF
	PSL-3	EE	EE	FF	EE	EE	FF

* Requires PTFE seals.

	EE-Sour Service	FF-Sour Service
Body	AISI 4130	ASTM A182 F6NM
Bonnet	AISI 4130	AISI 4130 / UNS S42 400
Stem	UNS S17400	UNS S17400
Bolting	ASTM A320 L7M	ASTM A320 L7M
Retaining Sleeve	ASTM A743 CF8M	ASTM A743 CF8M
Balance Sleeve	UNS S42 400	UNS S42 400
Seals	Viton	Viton

Other materials available upon request.

OTHER VALVE OPTIONS

	Standard	Optional
Calibration Head / Serial Plaque	Aluminum	Stainless Steel
Outlet Sleeve	-	Tungsten Carbide
Body Bleed Port	-	API Autoclave

Some limitations may apply.

ACTUATION OPTIONS

Master Flo	Other
Manually Operated	Rotary Electric
Rotary Stepping (Pneumatic)	Linear Hydraulic
Rotary Stepping (Hydraulic)	

Other actuators available upon request.

PERFORMANCE CHARACTERISTICS

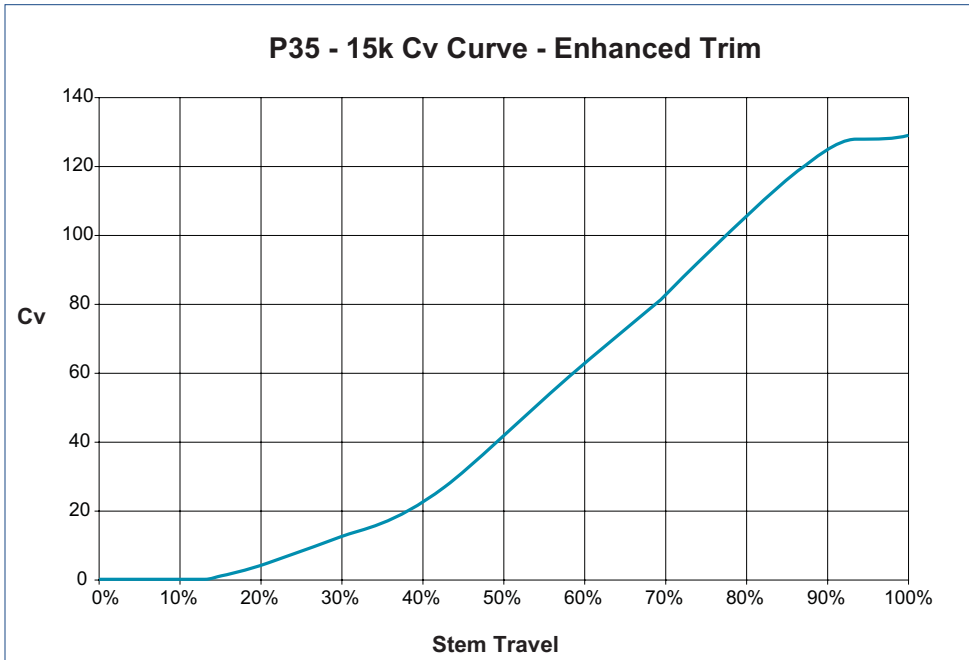

LIQUID PRESSURE RECOVERY FACTOR (FL)

Master Flo's trim geometry has been designed to achieve high F_L numbers. This results in a decreased cavitation potential, lower noise generation, increased flow capacity, and longer trim life. The high F_L numbers of Master Flo's trims have been verified experimentally as per the test procedures of ISA-S75.02-1996.

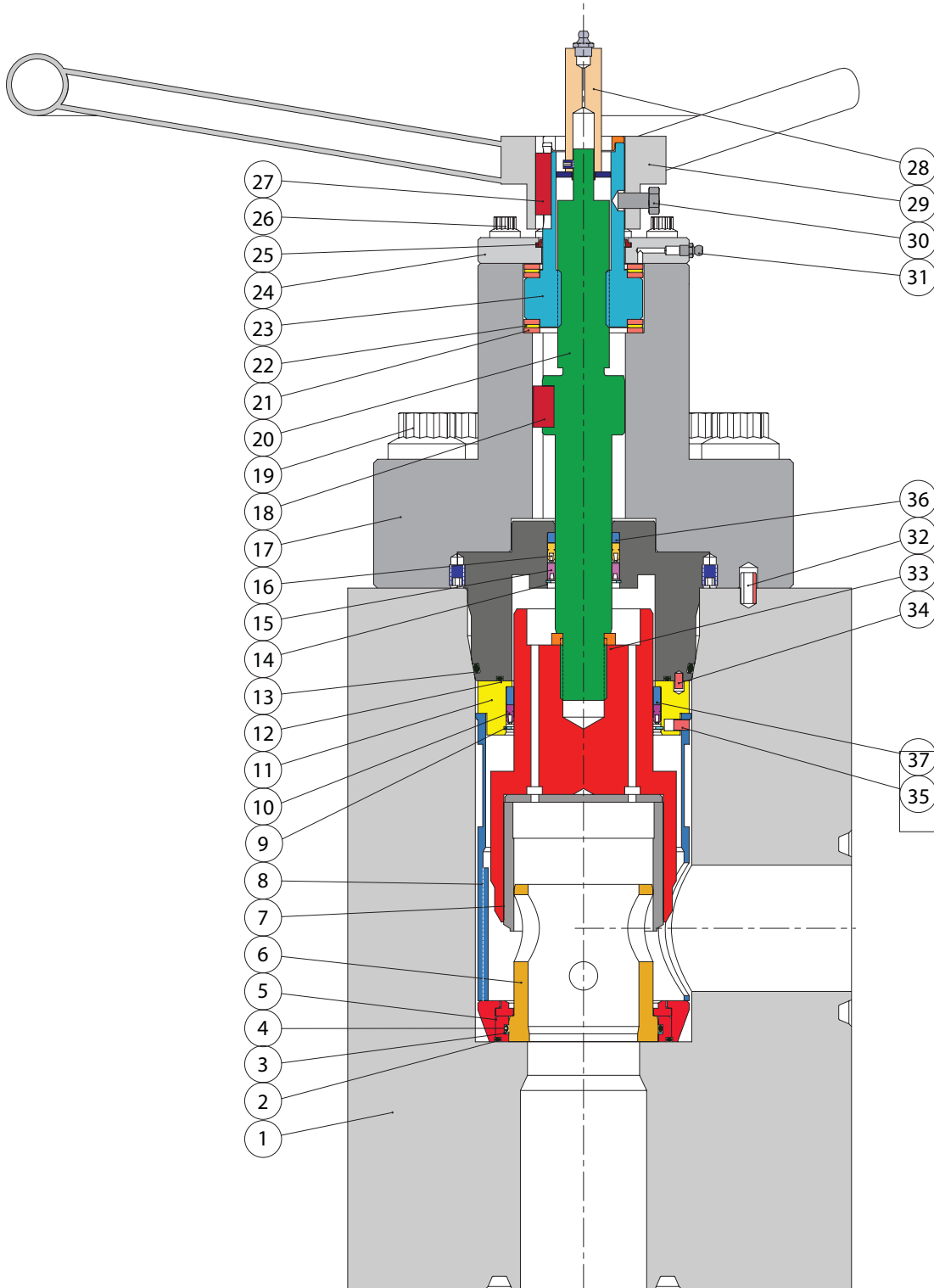

PARTS LIST

- 1. Body
- 2. Seal: Seat - Body
- 3. B/U Ring: Cage - Seat
- 4. Seal: Cage - Seat
- 5. Seat
- 6. Cage
- 7. External Sleeve
- 8. Retaining Sleeve
- 9. Retaining Ring
- 10. MSE Seal: External Sl. - Balance Sl.
- 11. Balance Sleeve
- 12. Seal: Balance Sleeve - Bonnet
- 13. Seal: Bonnet - Body
- 14. Retaining Ring
- 15. Bushing: Stem - Bonnet
- 16. MSE Seal: Stem - Bonnet
- 17. Bonnet
- 18. Key: Stem - Bonnet
- 19. Capscrew: Bonnet
- 20. Stem
- 21. Thrust Washer
- 22. Thrust Bearing
- 23. Stem Nut
- 24. Cover Plate
- 25. Wiper
- 26. Capscrew: Cover Plate
- 27. Key
- 28. Calibration Head
- 29. Handwheel
- 30. Capscrew
- 31. Grease Nipple
- 32. Spring Pin
- 33. Lockwasher
- 34. Groove Pin
- 35. Groove Pin
- 36. Bushing: Stem - Bonnet
- 37. Bushing: Balance Sl. - External Sl.

P35 Product Family

Standard:
 • P35E Bolted Bonnet; 6 000 PSI

Other Options:
 • **P35E 15K** - Bolted Bonnet; 15 000 PSI

chokes for all applications

recycle lines



manifold



vent valves



production



blow down

glycol injection

overboard dumps



subsea



level controllers

water injection

