

E P25E - 15K Series-2 Choke



15 000 psig / Max Cv 42 / Max Bean Size 100

This choke valve uses a bolted bonnet to retain the flow trim in the valve body. The flow trim is pressure balanced to minimize the stem loads and provide low operating torques. Standard end connections range in size from 2" to 3".

VALVE SPECIFICATIONS

Valve Model	P25E 15K
Body Type	Right Angle
Body Rating	15 000 PSIG (Maximum C.W.P.)
Inlet Connection	see 'Standard End Connections'
Outlet Connection	see 'Standard End Connections'
Bonnet Type	Bolted
Body / Bonnet Material	see 'Material Options'
Stem Material	see 'Material Options'
Seal Material	see 'Material Options'
Trim Style	Ported Cage with External Sleeve
Balanced / Unbalanced	Balanced
Flow Characteristic	Equal Percentage
Trim Material	see 'Trim Options'
Design Cv	see 'Trim Options'
Leakage Class	Class V (Standard)



TRIM OPTIONS

	Standard Trim Cage & External Sleeve 2 Row / 4 Hole
Material	Tungsten Carbide
Application	Liquid, Gas, Multiphase; Clean or Abrasive
Cv	42
Turns	8.5
Travel	1.41"

STANDARD END CONNECTIONS

Connection Size ▶	Standard Dimensions & Estimated Weights											
	2" Nominal				2 1/2" Nominal				3" Nominal			
	'I' or 'O'		Weight		'I' or 'O'		Weight		'I' or 'O'		Weight	
Connection Type ▼	inch	mm	lbs.	kg	inch	mm	lbs.	kg	inch	mm	lbs.	kg
ASME 150 RF	7.75	197	175	79	8.00	203	184	84	8.00	203	186	84
ASME 300 RF	8.00	203	179	81	8.25	210	189	86	8.38	213	197	89
ASME 600 RF	8.38	213	206	94	8.62	219	194	88	8.75	222	258	117
ASME 600 RTJ	8.44	214	206	94	8.69	221	194	88	8.81	224	258	117
ASME 900 RF	9.50	241	218	99	9.62	244	231	105	9.50	241	269	122
ASME 900 RTJ	9.56	243	218	99	9.69	246	231	105	9.56	243	269	122
ASME 1500 RF	9.50	241	218	99	9.62	244	231	105	10.12	257	289	131
ASME 1500 RTJ	9.56	243	218	99	9.69	246	231	105	10.19	259	289	131
ASME 2500 RTJ	n/a	n/a	n/a	n/a	11.25	286	278	126	12.25	311	351	159
2 000 API 6B	8.44	214	206	94	8.69	221	194	88	8.81	224	258	117
3 000 API 6B	9.56	243	218	99	9.69	246	231	105	9.56	243	269	122
5 000 API 6B	9.56	243	218	99	9.69	246	231	105	10.19	259	289	131
10 000 API 6BX	9.56	243	218	99	10.12	257	233	106	10.75	273	293	133
15 000 API 6BX	10.25	260	229	104	10.69	271	255	116	11.25	286	318	144

ENVELOPE DIMENSIONS

Dimensions 'A', 'B', and 'C' apply to manually operated chokes and are tabulated below. 'I' (inlet) and 'O' (outlet) dimensions depend on the end connections and are tabulated above. Special dimensions and other end connections are available upon request.

Dimensions		
	inch	mm
A	17.00	432
B	18.00	457
C	24.75	629

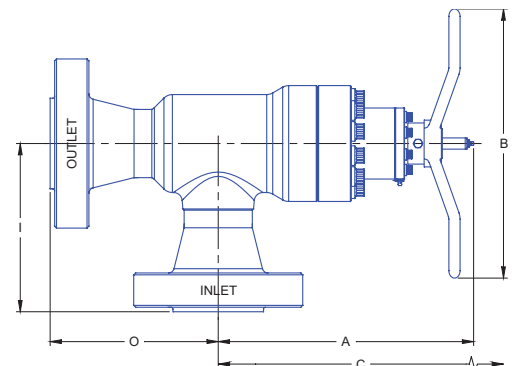

Note: "C" is the disassembly clearance.



6A-0138

17D-0008

MATERIAL OPTIONS

Temperature Class	Certification Level	API - 6A Material Class Designations							
		AA	BB	CC	DD	EE	FF	HH	
PU -20F to 250F	STD / PSL-1	EE	EE	FF	EE	EE	FF	HH	
PX -20F to 350F	PSL-2	EE	EE	FF	EE	EE	FF	HH	
	PSL-3	EE	EE	FF	EE	EE	FF	HH	
LU -50F to 250F	STD / PSL-1	EE	EE	FF	EE	EE	FF	HH	
LX -50F to 350F	PSL-2	EE	EE	FF	EE	EE	FF	HH	
	PSL-3	EE	EE	FF	EE	EE	FF	HH	

	EE-Sour Service	FF-Sour Service	HH-Sour Service
Body	AISI 8620	UNS S31803	AISI 8620 / Inconel 625
Bonnet	AISI 4130	AISI 4130 / ASTM A182	AISI 4130 / Inconel 718
Stem	UNS S17400	UNS S17400	Inconel 718
Bolting	ASTM A320 L7M	ASTM A320 L7M	ASTM A320 L7M
Retaining Sleeve	ASTM A743 CF8M	ASTM A743 CF8M	Inconel 625
Balance Sleeve	ASTM A182 F6NM	ASTM A182 F6NM	Inconel 718
Seals	Viton	Viton	Viton

Other materials are available upon request.

OTHER VALVE OPTIONS

	Standard	Optional
Calibration Head / Serial Plaque	Aluminum	Stainless Steel
Outlet Sleeve	-	Stainless Steel , Tungsten Carbide
Body Bleed Port	-	API Autoclave

Some limitations may apply.

ACTUATION OPTIONS

Master Flo	Other
Manually Operated (Stemlock is optional)	Rotary Electric
Rotary Stepping (Pneumatic)	Pneumatic Piston
Rotary Stepping (Hydraulic)	
FC Hydraulic Piston	
Pneumatic Piston	

Other actuators are available upon request.

PERFORMANCE CHARACTERISTICS

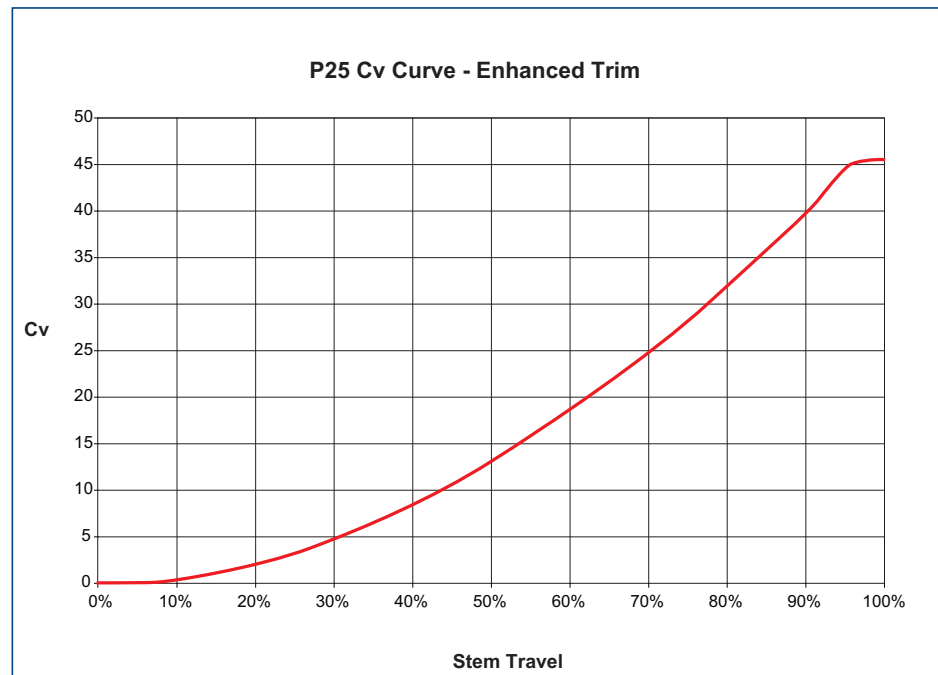

LIQUID PRESSURE RECOVERY FACTOR (FL)

Master Flo's trim geometry has been designed to achieve high F_L numbers. This results in a decreased cavitation potential, lower noise generation, increased flow capacity, and longer trim life.

The high F_L numbers of Master Flo's trims have been verified experimentally as per the test procedures of ISA-S75.02-1996.

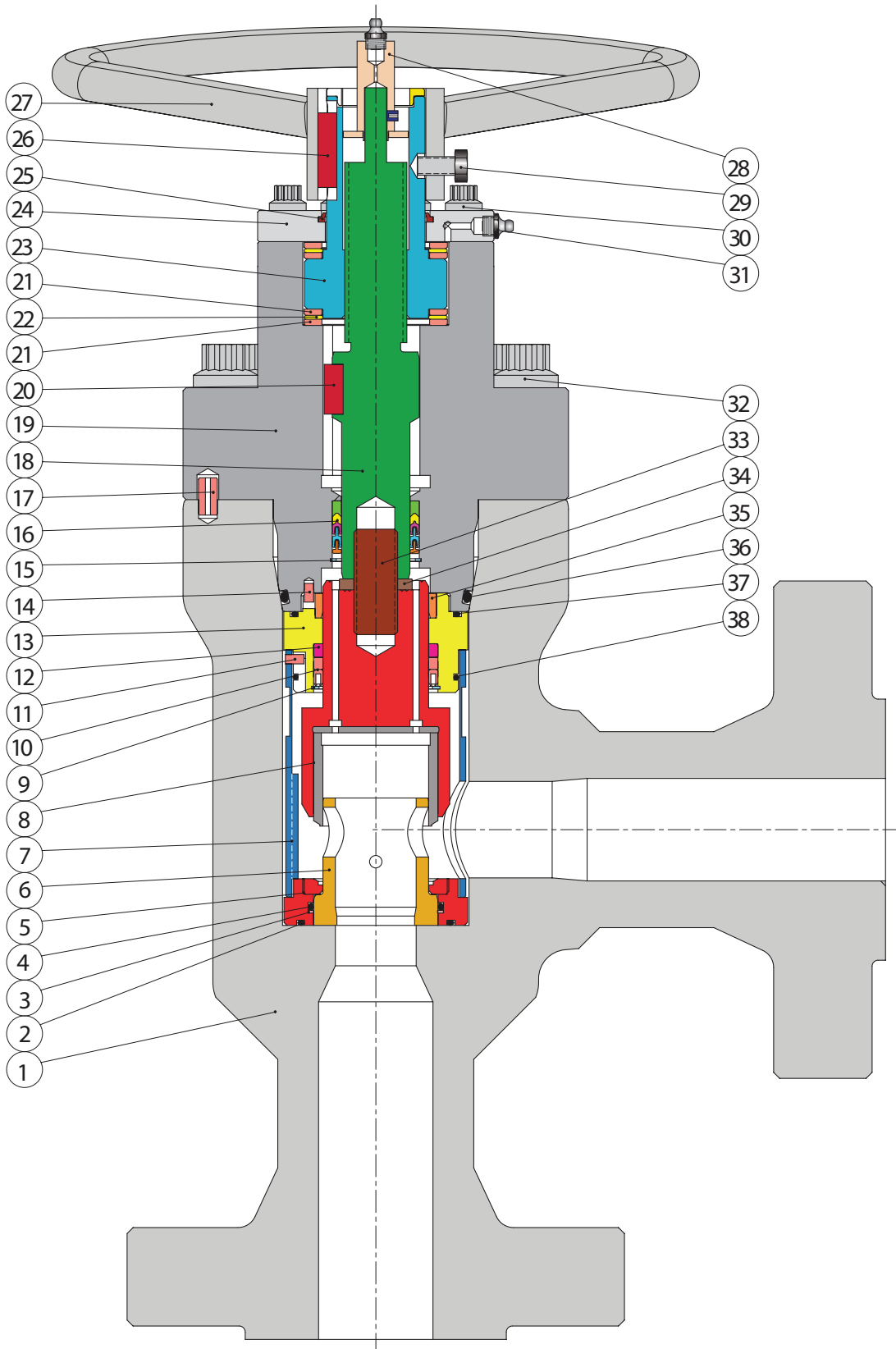

PARTS LIST

1. Body
2. Seal: Seat - Body
3. B/U Ring: Cage - Seat
4. Seal: Cage - Seat
5. Seat
6. Cage
7. Retaining Sleeve
8. External Sleeve
9. Retaining Ring
10. MSE Seal
11. Pin
12. External Sleeve Bushing
13. Balance Sleeve
14. Pin
15. Retaining Ring
16. Seal Pack: Stem - Bonnet
17. Spring Pin
18. Stem
19. Bonnet
20. Key
21. Thrust Washer
22. Thrust Bearing
23. Stem Nut
24. Cover Plate
25. Wiper
26. Key
27. Handwheel
28. Calibration Head
29. Capscrew
30. Capscrew
31. Grease Nipple
32. Capscrew
33. Stud
34. Lockwasher
35. External Sleeve Bushing
36. Seal: Bonnet - Body
37. Seal: Balance Sleeve - Bonnet
38. Seal: Balance Sleeve - Retaining Sleeve

P25 Product Family

Standard:

- P25E - Hammer-Union Bonnet; 5000 PSI

Other Options:

- P25E BB - Bolted Bonnet; 6 000 PSI
- **P25E 15K - Bolted Bonnet; 15 000 PSI**
- P25E HT - Hammer Union; 5 000 PSI; High-Temperature Service
- C25E - Hammer Union; 3 600 PSI; Inline
- C25E BB - Bolted Bonnet; 3 600 PSI; Inline
- C25E HT - Hammer Union; 3 600 PSI; Inline; High Temperature Service

WORLDWIDE LOCATIONS

Canada

Master Flo Valve Inc.
4611 - 74 Avenue
Edmonton, Alberta
Canada T6B 2H5
Tel.: 1 780 468-4433
Fax: 1 780 469-9853

#400, 202 - 6 Avenue SW
Calgary, Alberta
Canada T2P 2R9
Tel.: 1 403 237-5557
Fax: 1 403 266-3307

United States

Master Flo Valve (USA) Inc.
Houston, Texas USA 77064
Tel.: 1 713 690-2789
Fax: 1 281 517-0007

Scotland

Master Flo Valve Co. (UK) Ltd.
Aberdeen, Scotland AB12 3LH
Tel.: 44 (0)1224 878999
Fax: 44 (0)1224 878989

France

Master Flo Valve (France) SARL
Pau, France
Tel.: 33 (0)5 5992-8229
Fax: 33 (0)5 5992-8261

Brazil

Master Flo Valve Inc.
Rio de Janeiro, Brazil
Tel.: 55 (0)21 2532-5618
Fax: 55 (0)21 2220-7677

United Arab Emirates

Master Flo Valve Inc.
Regional Representative Office
Abu Dhabi, UAE
Tel.: 971 (0)2 6329150
Fax: 971 (0)2 6321276

Indonesia

Master Flo Valve Inc.
Jakarta, Indonesia
Tel.: 62 (0)21 7918.1234
Fax: 62 (0)21 7918.2575

Malaysia

Master Flo Valve Asia SDN. BHD.
Kuala Lumpur, Malaysia
Tel.: 60 (0)3 2078-7688
Fax: 60 (0)3 2078-7689

China

Master Flo Valve Inc.
Beijing Representative Office
Beijing, People's Republic of China
Tel: 86 (0)10 6583 0338
Fax: 86 (0)10 6583 3006

Latin America

Master Flo Valve Inc.
Argentina
Tel.: 54 (911) 5810-8044

masterflo.com | info@masterflo.com

MASTER FLO
The leader in choke technology™

