

E C1E High-Temperature Valve

3 600 psig / Max Cv 14 / Max Bean Size 58

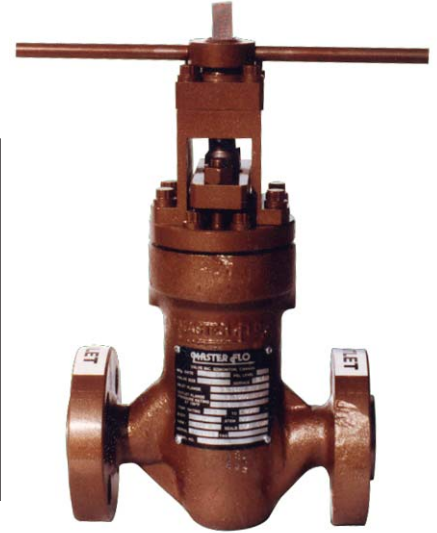

This control-valve option, suitable for high-temperature applications, uses a bolted bonnet to retain the flow trim in the valve body. Standard end connections range in size from 1" to 2".



VALVE SPECIFICATIONS

Valve Model	C1E HT
Body Type	Inline
Body Rating	3 600 PSIG (Maximum C.W.P.)
Inlet Connection	see 'Standard End Connections'
Outlet Connection	see 'Standard End Connections'
Bonnet Type	Bolted
Body / Bonnet Material	see 'Material Options'
Stem Material	see 'Material Options'
Seal Material	see 'Material Options'
Trim Style	Ported Cage with External Sleeve
Balanced / Unbalanced	Unbalanced
Flow Characteristic	Equal Percentage
Trim Material	see 'Trim Options'
Design Cv	see 'Trim Options'
Leakage Class	Class V (Standard)

TRIM OPTIONS

	Standard Trim Cage & External Sleeve 2 Row / 4 Hole
Material	UNS S17400, Stellite
Application	Liquid, Gas, Multiphase; Clean
Cv	14
Turns	6
Travel	1.00"

STANDARD END CONNECTIONS

Connection Size ▶	Standard Dimensions & Estimated Weights							
	1" Nominal				2" Nominal			
	'F'		Weight		'F'		Weight	
Connection Type ▼	inch	mm	lbs.	kg	inch	mm	lbs.	kg
Threaded	8.25	210	37	17	-	-	-	-
ASME 150 RF	*8.50	*216	38	17	*10.50	*267	51	23
ASME 300 RF	*8.75	*222	41	19	10.50	267	51	25
ASME 600 RF	*9.38	*238	42	19	11.25	286	55	25
ASME 600 RTJ	*9.38	*238	49	22	11.38	289	55	40
ASME 900 RF	11.50	292	49	22	14.75	375	88	40
ASME 900 RTJ	11.50	292	49	22	14.88	378	88	40
ASME 1500 RT	11.50	292	49	22	14.75	375	88	40
ASME 1500 RTJ	11.50	292	49	22	14.88	378	88	40

* Not a standard ISA face-to-face dimension.

ENVELOPE DIMENSIONS

Dimensions 'A', 'B', and 'C' apply to manually operated valves and are tabulated below. 'F' (face-to-face) dimension depends on the end connection and is tabulated above. Special dimensions and other end connections are available upon request.

Dimensions		
	inch	mm
A	14.16	360
B	13.00	330
C	20.00	508
D	2.94	75

Note: "C" is the disassembly clearance.

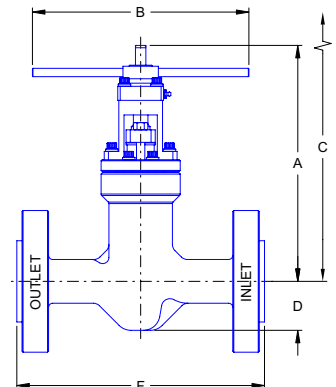

MATERIAL OPTIONS

Temperature Class	Certification Level	API - 6A Material Class Designations						
		AA	BB	CC	DD	EE	FF	HH
PU -20F to 750F	STD / PSL-1	BB	BB	CC	n/a	n/a	n/a	n/a
	PSL-2	BB	BB	CC	n/a	n/a	n/a	n/a
	PSL-3	BB	BB	CC	n/a	n/a	n/a	n/a

	BB-General Service	CC-General Service
Body	ASTM A352 LCC / ASTM A216 WCB	ASTM A351 CF8M
Bonnet	ASTM A350 LF2 or AISI 4130	AISI 316
Stem	UNS S17400	UNS S17400
Bolting	ASTM A320 L7M	ASTM A320 L7M
Retaining Sleeve	ASTM A743 CF8M	ASTM A743 CF8M
Seals	SS / Graphoil	SS / Graphoil

Other materials available upon request.

OTHER VALVE OPTIONS

	Standard	Optional
Calibration Head / Serial Plaque	Aluminum	Stainless Steel
Outlet Sleeve	-	n/a
Body Bleed Port	-	n/a

ACTUATION OPTIONS

Master Flo	Other
Manually Operated	Pneumatic Diaphragm

Other actuators available upon request.

PERFORMANCE CHARACTERISTICS

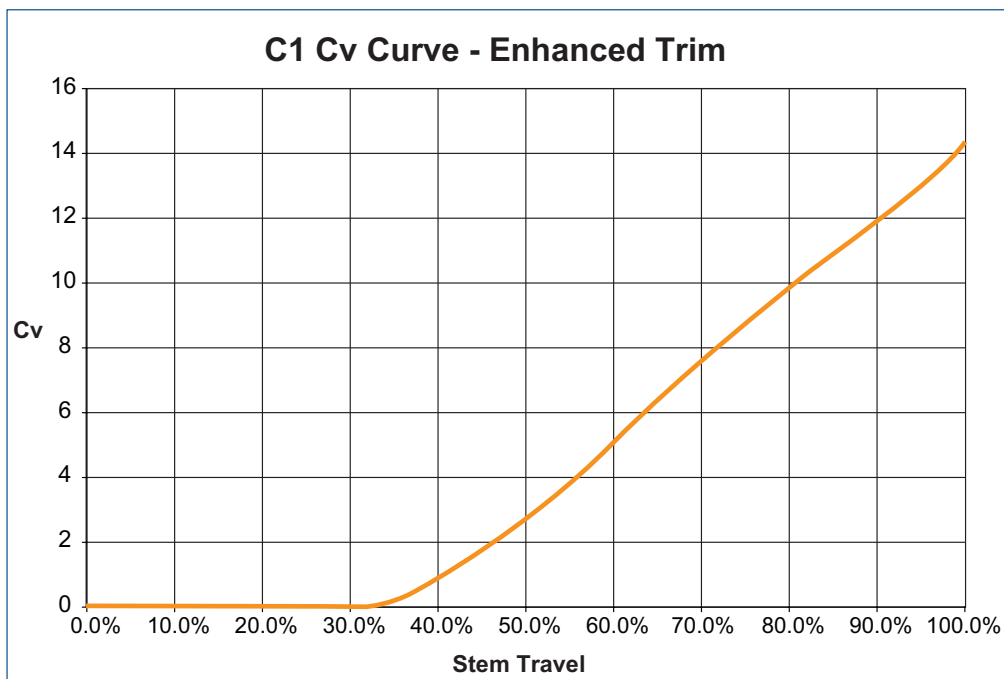

LIQUID PRESSURE RECOVERY FACTOR (FL)

Master Flo's trim geometry has been designed to achieve high F_L numbers. This results in a decreased cavitation potential, lower noise generation, increased flow capacity, and longer trim life.

The high F_L numbers of Master Flo's trims have been verified experimentally as per the test procedures of ISA-S75.02-1996.

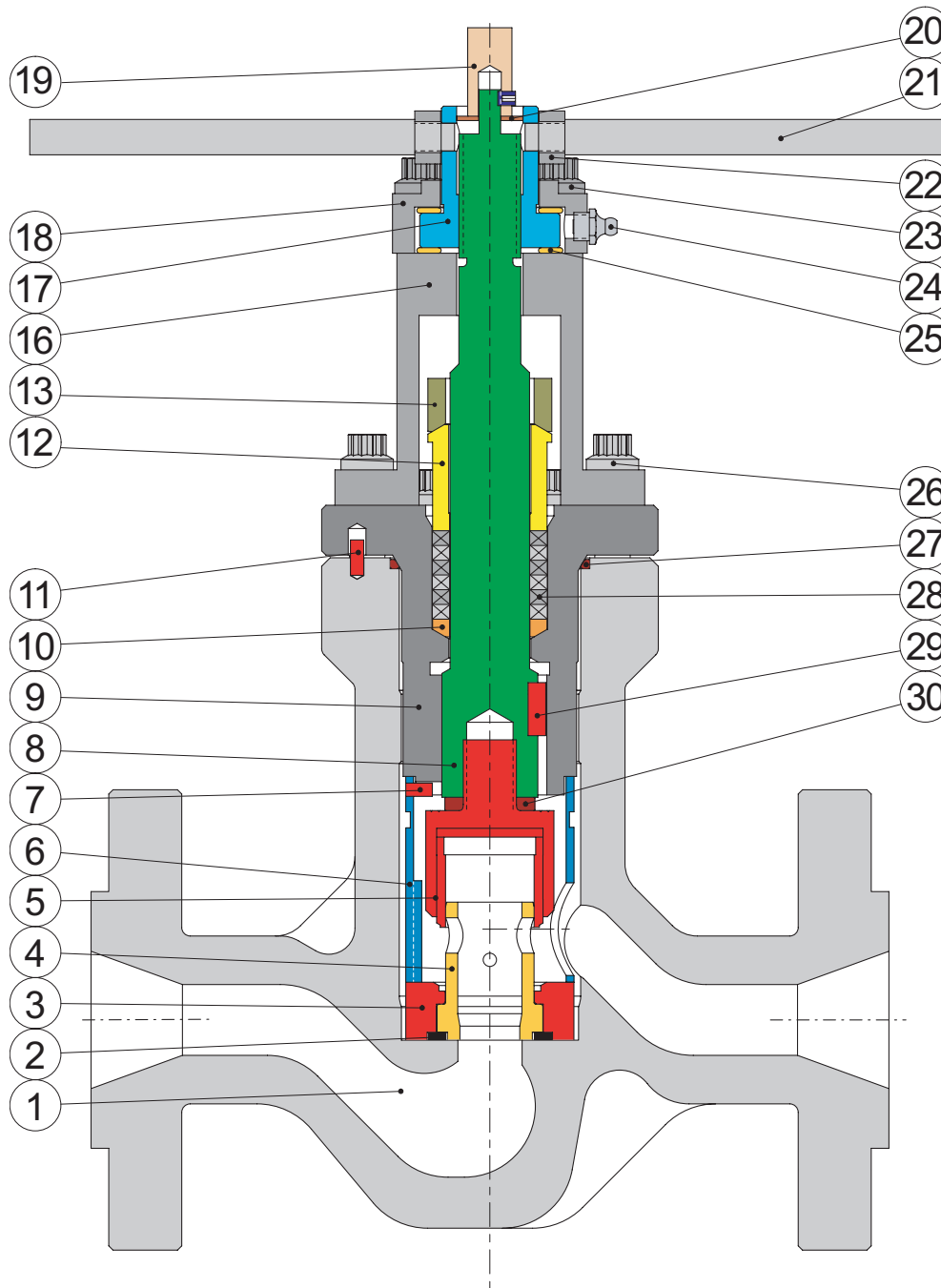

PARTS LIST

1. Body
2. Seal: Nozzle/Seat - Body
3. Seat
4. Cage
5. External Sleeve
6. Retaining Sleeve
7. Pin
8. Stem
9. Bonnet
10. Packing Leader
11. Pin
12. Packing Follower
13. Packing Gland
14. Nut (not visible)
15. Stud (not visible)
16. Yoke
17. Stem Nut
18. Cover Plate
19. Calibration Head
20. Stem Washer
21. Handle
22. Handle Ring
23. Capscrew
24. Grease Nipple
25. Thrust Washer
26. Capscrew
27. Seal: Bonnet - Body
28. Packing: Stem - Bonnet
29. Key
30. Lockwasher

P1E Product Family

Standard:

- P1E - Bolted Bonnet; 6 000 PSI

Other Options:

- P1E HT - Bolted Bonnet; 6 000 PSI; High-Temperature Service
- YP1E - Bolted Bonnet; 5 000 PSI; Y-Pattern Inline
- C1E - Bolted Bonnet; 3 600 PSI; Inline
- C1E HT - Bolted Bonnet; 3 600 PSI; Inline; High-Temperature Service

chokes
for all applications

recycle lines



vent valves



manifold



production



blow down

overboard dumps



subsea

glycol injection



level controllers

water injection



www.masterflo.com
info@masterflo.com
info@masterflo.co.uk