

ON | OFF VALVES

MANUAL VALVES & ACTUATED VALVES

- *Fast Track*
- *Standard Delivery*
- *Stock Availability*



ENGINEERED
PRODUCTS
& SERVICES

E.P.&S.

Your Valve Specialist in Africa

Distributor in Western and Central Africa
for MT GROUP On / Off Valves

MT GROUP



E.P.&S.

Your Valve Specialist in Africa



E.P.&S. was established in 2009 and over the years has become **Your Valve Specialist in Africa**. We specialize in offering tailored valve solutions including fast track or standard lead times – and cater from large valve packages to single valve requirements. We carry our own stock of API6D Ball Valves with offshore painting as standard – all readily available from our warehouse facility, located in Antwerp, Belgium!... *Please see attached Flyer for more details.*

We are specialist valve suppliers of a diverse range of valves including **Manual & Actuated On / Off Valves** (including Emergency Shutdown Valves, Blow Down Valves & Actuated Valves), Control Valves, API 6A Wellhead Valves & Control Panels, Choke Valves, Vibration Analysis Solutions, Rupture Disks & Tank Protection. We can also supply a full range of accessories (actuators, positioners, solenoid valves, gauges, fittings) in support of such equipment, and are able to offer tailor-made solutions for the most challenging applications.

Our customer base is extremely diverse and includes oil and gas (production, refining, storage, distribution), chemical, food and energy companies. Our presence extends from the end users to integrators and installers as well.

E.P.&S. is your distributor in Angola, Cameroon, Chad, Congo, Equatorial Guinea, Gabon, Ghana, Guinea Conakry, Ivory Coast, Niger, Senegal, we can offer locally-based technical and commercial support to our customers.

Our reputation rests not only on technical expertise when managing solutions, local knowledge and the supply of quality products, but also on diversity of sourcing, which enables us to meet our customers' specific needs and urgency.

E.P.&S. presents you **ON-OFF Valves** from the **MT Group**, it includes : Ball Valves, Gate Valves, Globe Valves, Check Valves, Plug Valves and Butterfly Valves. These valves are widely used in the oil, gas, chemical industry, power station, offshore, and water treatment, as well as various other industrial systems.

Product size ranges from 1/2 to 72 inches and pressure class ranges from Class 150 to 2500. All products are in strict compliance with API, ASME, ANSI, DIN, ISO, GB and other reputed international standards. The factories & Foundries under **MT Group** have all the expected international certifications including: ISO 9001, ISO 14001, ISO 18001, CE, API 6D, API 600, API 607, API 6FA, TS,... *Ensuring you of a quality product.*

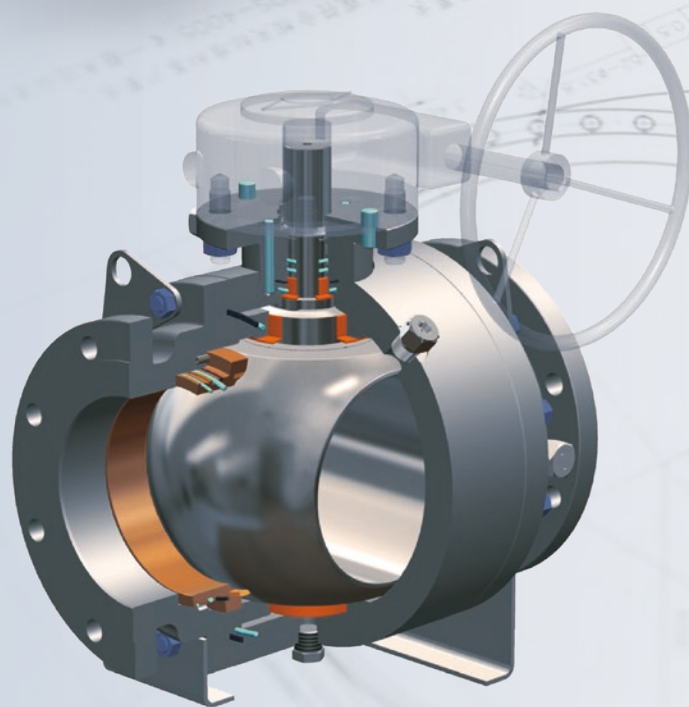

MT Group Valves Quality Control

MT Group's factories are equipped with precise measurement and testing equipment to perform UT, MT, PT, PMI, Impact Test, Tensile test, CMM, High Temperature Test, Cryogenic Test, Low Emission Test, High Pressure Gas Test, Paint Thickness Test, Surface Roughness Test, Hydraulic Test, etc. Entire supply chain management from raw material purchasing until finished goods every process is under control.



PRESSURE
TEST



TORQUE
TEST



NONDESTRUCTIVE
TEST(NDT)

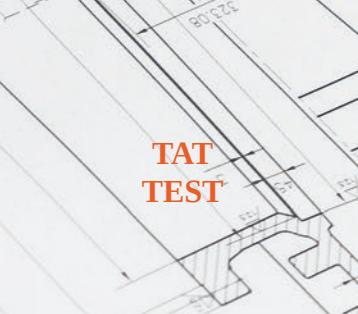

TAT
TEST



COORDINATE
MEASURING
MACHINE



CRYOGENIC
TEST



HEAT
TREATMENT
FURNACE



INDUSTRIAL
VALVE
MANUFACTURER



E.P.&S. distributes the leading of MT Group products include Ball Valves, Gate Valves, Globe Valves, Check Valves, Plug Valves and Butterfly Valves, which are widely used in the oil, gas, chemical industry, power station, offshore, and water treatment, as well as various other industrial systems.



MT Group Valves *Design Features*



ANTI-BLOWOUT STEM DESIGN:

The overall T-shaped structure at the bottom of the stems or optional pendant collect design can prevent the stem from blowing out under pressure.

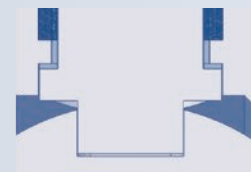

ANTI-STATIC DEVICE:

Standard feature of ball valves a spring between the ball and stem or between stem and body permits electrical continuity between all valves components.

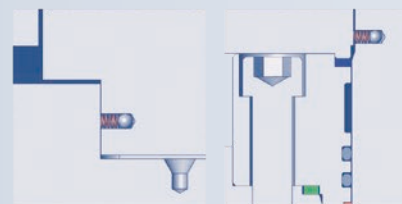

FIRE TYPE-TESTING DESIGN:

The ball valves are designed with a secondary metal-to-metal seal. After a fire the fire-safe seals energize the seat assembly to seal. For floating valves. Ball is pushed to keep touch with fire-safe lip. For trunnion mounted ball valve, seat is pushed to keep touch with ball by line pressure with spring force.



DBB & DIB DESIGN:

Per request DBB, DIB-I or DIB-II seat design is available based on work conditions.

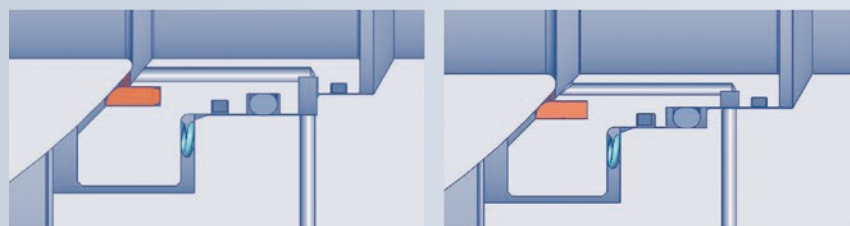

METAL TO METAL SEATED DESIGN:

Metal-seated ball/seats and high performance graphite sets are available in complex conditions such as high temperature, high pressure and particle medium, etc.

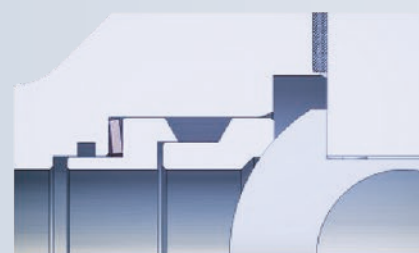

VENT / DRAIN / EMERGEN INJECTION GREASE:

Drain and vent are standard feature in ball valve to ensure pressure relief and cavity drain, Sealant injection systems located on the stem and seat can be utilized in case of emergencies. A second internal check valve provides back up to the fitting.

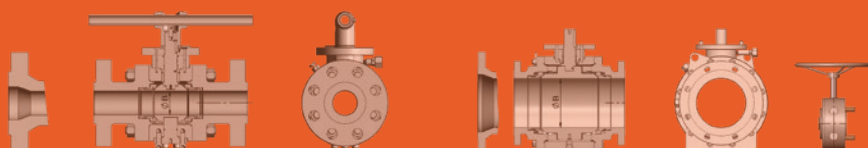
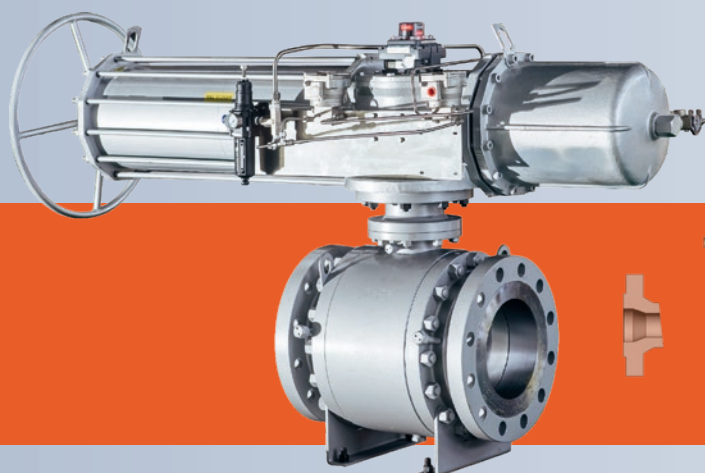
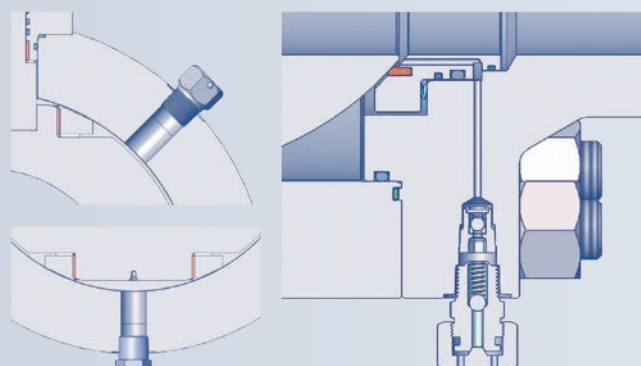

E.P.&S.

Reliable Valve Automation Solutions

E.P.&S. bring to you engineered flow control solutions for Oil & gas, Power & process industries. The **MT Group** valves are unique for their reliability, constant performance and low torque requirements which remain steady with no fluctuations when automated with actuators over a period of sustained usage ensuring drop-tight shutoff in critical operating conditions. E.P.&S. leverages its manufacturers inhouse capabilities in system design, manufacture, integration and testing to offer a comprehensive range of Valve Automation Solutions that go beyond industry standards and surpass customer expectations.

The Valve Automation solutions include:

- Emergency Shut Down Valves (ESDV)
- Shut Down Valves (SDV)
- Blowdown Valves (BDV)
- On / Off Valves
- Remote Operated Valves
- Motor-operated Valves

The Emergency Shutdown / Blow Down Valves (ESDV / SDV / BDV) are built on Quarter-turn (Ball & Butterfly) and Linear (Gate & Globe) Valves.

ESDV Features include:

- Fast closing / opening - operating time less than 2 seconds
- Fail-safe configuration (Open / Close / Stay-put)
- Redundancy - 1oo2 / 2oo3 for Solenoid Valve
- Partial Stroke Test (PST) facility
- Open / Close Position Indicator

Options:

- Fire-proof system (Fusible Plug, Fire box, Jacketing or Coating)
- ESD via Momentary / Pulse signal
- Instruments mounted on IP cabinet box
- Local Control Station (LCS) with customized local operating function
- Manual open / close
- Back-up Air Volume Tank
- Pneumatic ESD control without electric source



E.P.&S. engineers can size the valve you require, then working with one of our many partners, we can select an automation facility to fit actuators and accessories and undertake torque testing and hydrostatic and pneumatic testing all in-house.



<ul style="list-style-type: none"> <input type="checkbox"/> Solenoid Valves <input type="checkbox"/> Limit Switches <input type="checkbox"/> Positioners <input type="checkbox"/> Air Filter Regulators + Quick Exhaust Valves + Volume Boosters + Local Control Stations (LCS) 	<ul style="list-style-type: none"> <input type="checkbox"/> Ball Valves <ul style="list-style-type: none"> Floating / Trunnion Mounted <input type="checkbox"/> Butterfly Valves <input type="checkbox"/> Gate Valves <input type="checkbox"/> Globe Valves 	<ul style="list-style-type: none"> <input type="checkbox"/> Pneumatic Actuators <input type="checkbox"/> Hydraulic / Electro-hydraulic Actuators <input type="checkbox"/> Electrical Actuators <input type="checkbox"/> Gas-over-Oil Actuators
<p>Solenoid Valves:</p> <ul style="list-style-type: none"> • 3/2-way and 5/2-way • Auto and Manual Reset / Class F or H coil • De-Energize: Open / De-Energize: Close • Operating power: AC / DC Supply • Body MOC: Brass / Al / SS 	<p>Ball Valves - Floating / Trunnion Mounted:</p> <ul style="list-style-type: none"> • Operating Time: Less than 2 seconds • API 6D, Fire-safe API 6FA / API 607 / ISO 10497 • Leakage Class: ISO 5208, Rate A (Soft-seated) • Leakage Class: ISO 5208, Rate B (Metalseated) • Fugitive Emission: ISO 15848 Class B / A • Options: Double-piston Effect • Size: up to 60", Class 150 to 2500 	<p>Pneumatic Actuators:</p> <ul style="list-style-type: none"> • Linear / Rotary • Rack-and-Pinion / Scotch Yoke • Piston type - Single-acting / Double-acting • Fast acting with cushioning arrangement • Certification: SIL / PED
<p>Limit Switches:</p> <ul style="list-style-type: none"> • Micro / Proximity Switch • SPDT / DPDT / Non-contact type • Protection: Hermetically-sealed • Extended open / close indication (optional) • Operating power: AC / DC Supply • Enclosure MOC: Al / SS 	<p>Butterfly Valves:</p> <ul style="list-style-type: none"> • Operating Time: Less than 5 seconds • API Monogram, Fire-safe API 607 / ISO 10497 • Leakage Class: API 598 Resilient Seated • Fugitive Emission: ISO 15848 Class B / A • Size: up to 60", Class 150 to 600 	<p>Hydraulic / Electro-hydraulic Actuators:</p> <ul style="list-style-type: none"> • Linear / Rotary • Scotch Yoke / Rack-and-Pinion (Hydraulic only) • Piston type – Single-acting / Double-acting • Electrical failsafe • With External Hydraulic Power pack
<p>Positioners:</p> <ul style="list-style-type: none"> • Partial Stroke Test • Electro-pneumatic / SMART (HART / FF) • Advance Diagnostics with Software • Operating power: 24V DC / 4-20mA • Enclosure MOC: Al / SS 	<p>Gate Valves:</p> <ul style="list-style-type: none"> • Operating Time: 1 second / inch • API 600 / ASME B16.34, ISO 10497 • Leakage Class: API 598 / MSS SP-61 • Fugitive Emission: ISO 15848 Class B • Size: 1/2" to 72", Class 150 to 2500 	<p>Electrical Actuators:</p> <ul style="list-style-type: none"> • Linear / Rotary • Intrusive & Non-intrusive • On-Off / Inching / Modulating Duty • Integral or Non-integral Starter • Electrical fail-safe • Communication: Hardwire / Modbus / Profibus / FF
<p>Air Filter Regulators:</p> <ul style="list-style-type: none"> • Manual / Auto Reset • Filter Element: Sintered Bronze / Polycarbonate / Polyethylene / SS • Body MOC: Aluminum / Stainless Steel • Filter Element Size: 5µ / 25µ / 40µ • Inlet & Outlet Pressure Gauge 	<p>Globe Valves:</p> <ul style="list-style-type: none"> • Actuation options: Pneumatic, Electric • API 6D / ISO 14313, ISO 10497 • Leakage Class: ISO 5208, Rate A (Softseated) • Fugitive Emission: ISO 15848 Class B • Size: 2" to 24", Class 150 to 2500 	<p>Gas-over-Oil Actuators:</p> <ul style="list-style-type: none"> • Pipeline gas used as power source • Linear / Rotary • Scotch Yoke • Piston type - Double-acting • Electrical failsafe



MT Group Ball Valves

TRUNNION MOUNTED BALL VALVES

Pressure Rating:

Class 150 - 300 - 600 - 900 - 1500 - 2500

Design Standard:

API 6D

Maxsize:

NPS 60"

Design Structure:

Side Entry / Top Entry, Soft Seat / Metal Seat / O-ring Seal /
Lipseal, DBB, DIB-1, DIB-2, Casting Steel / Forged Steel



FLOATING BALL VALVES

Pressure Rating:

Class 150 - 300 - 600 - 900 - 1500 - 2500

Design Standard:

ISO 17292, API 608, ASME B16.34

Maxsize:

NPS 10"

Design Structure:

Side Entry / Top Entry, Soft Seat / Metal Seat, Casting Steel /
Forged Steel



DBB DOUBLE BALL VALVES

Pressure Rating:

Class 150 - 300 - 600 - 900 - 1500 - 2500

Maxsize:

NPS 24"

Design Structure:

Double ball, compact design, DBB



E.P.&S. can provide your choice of actuator brand or select from one of our partners range of ex-stock brands. We also designs and supply failsafe systems, control panels etc. We perform all fitting, instrumentation, and testing (function/ stroke, open & close speed, functionalities, etc).

E.P.&S. | MT Group

Overview of all Products

GATE VALVES

Wedge Gate Valves

#150 - 2500lb

Parallel Slide Gate Valves

#300 - 2500lb

Pressure Seal Gate valves

#600 - 2500lb

Through Conduit Gate valves

#150 - 900lb

Cryogenic Gate Valves

#150 - 2500lb

Main Design

API 600 / API 602 /

API 603 / API 6D /

ASME B16.34 / MSS SP144

Maximum Size: 60"



CHECK VALVES

Swing Check Valves

#150 - 2500lb

Lift Type Check Valves

#150 - 600lb

Pressure Seal Bonnet

Check Valves

#600 - 2500lb

Cryogenic Check Valves

#150 - 2500lb

Main Design

API 602 / API 594 / BS1868 /

ASME B16.34 / MSS SP144

Maximum Size: 48"



AXIAL CHECK VALVES

Axial Check Valves

#150 - 2500lb

Cryogenic Axial

Check Valves

#150 - 600lb

Main Design: API 6D

Maximum Size: 48"



DUAL PLATE CHECK VALVES

Dual plate Check Valves

#150 - 2500lb

Wafer / Lug / Double flange /

Hub end Soft or metal seat

Cryogenic Dual plate

Check Valves

#150 - 300 lb

Main Design

API 594/API 6D

Maximum Size: 72"



GLOBE VALVES

Globe Valves

#150 - 2500lb

Stop-Check Globe Valves

#150 - 2500lb

Pressure Seal Globe Valves

#600 - 2500lb

Cryogenic Globe Valves

#150 - 2500lb

Main Design

API 602 / BS 1873 /

API 623 / ASME B16.34 /

MSS SP144

Maximum Size: 20"



BALL VALVES

Trunnion Mounted Ball Valves

#150 - 2500lb

Side Entry / Top Entry, Soft Seat / Metal Seat, O-ring Seal / Lipseal, Double Block & Bleed, Cast / Forged options

Fully Welded Trunnion Mounted Ball Valves

#150 - 1500lb

Fully Welded Body, Side Entry, Soft Seat / Metal Seat, O-ring Seal, Double Block & Bleed, Underground Installation

DBB Ball Valves

#150 - 2500lb

Modular Body, Compact Design, Double Block & Bleed

Ball Valves

#150 - 2500lb

Cryogenic Ball Valves

#150 - 1500lb

-50°C~196°C, Side Entry / Top Entry, Soft Seat, Forged Steel

Main Design

API 6D/ISO 17292

Maximum Size: 48"



BUTTERFLY VALVES

Double Offset Butterfly Valves

#150 - 600lb

Wafer / Lug / Double Flange / Bi-directional Sealing

Triple Offset Butterfly Valves

#150 - 600lb

Wafer / Lug / Double Flange

Main Design

API 609

Maximum Size: 48"

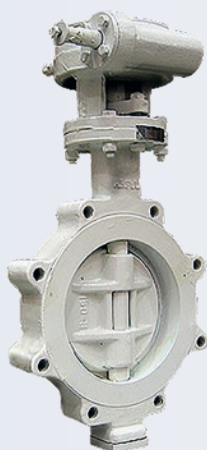

PLUG VALVES

Lubricated Plug Valves

#150 - 600lb

Pressure Balance

Sleeved Plug Valves

#150 - 600lb

Soft Seat, Self-lubricated

Main Design

API 599/API 6D

Maximum Size: 24"



SAFETY VALVES

Pressure Class

150 - 300 - 600 - 900 - 1500 - 2500

Operation Temperature

-196°C~538°C

Main Design

ASME VIII

Maximum Size: 8"

Material

Carbon Steel, Stainless Steel, Special Material per client requirement



Our own extensive stocks combined with our short delivery manufacturing supply base enables to E.P.&S. to provide all requirements from standard on-off valves to bespoke valve/actuator packages. We can provide tailored procurement solutions ranging from one-off's to large scale projects.

E.P.&S. | MT Group

Other References



◀ 12" Full Bore ESDV
Hydraulically Actuated
Pressure Class #1500
Body Material: Forged
Stainless Steel (A182 F316)
Trim Material: Stainless Steel
Fast track delivery: 4 weeks

 ENGINEERED
PRODUCTS
& SERVICES **E.P.&S.**
Your Valve Specialist



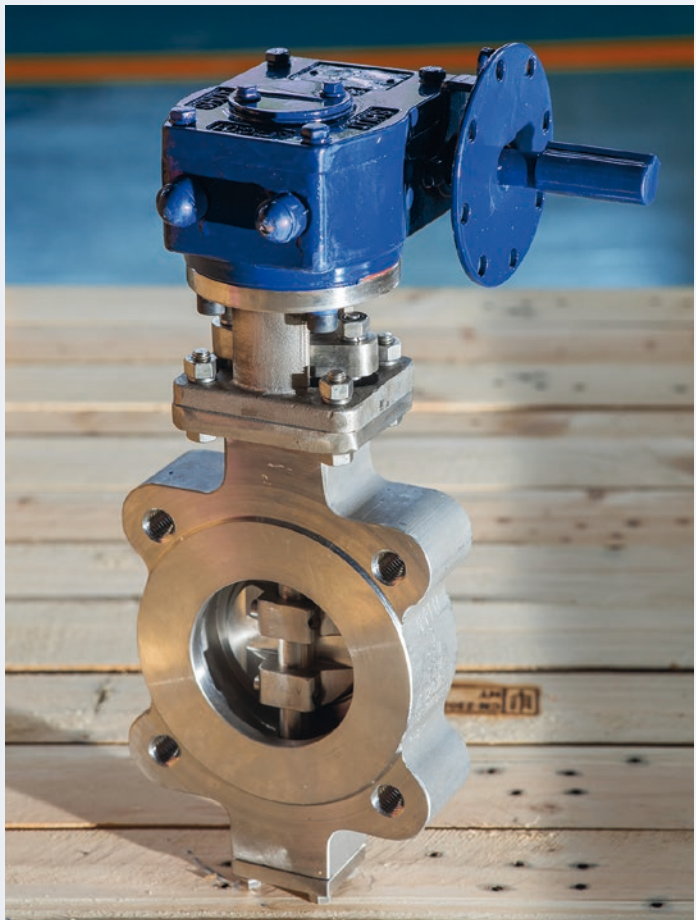
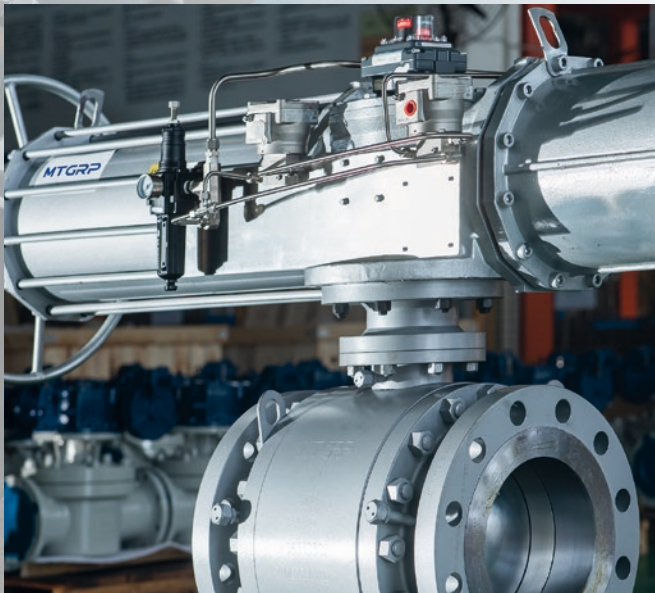

REFERENCES

ACTEMIUM Cameroon, Congo - ADDAX Cameroon, Gabon - ASSALA Gabon - ATLANTIC METHANOL Equatorial Guinea - BP Angola
BW OFFSHORE Gabon - CHEVRON Angola - CORAF Congo - CSS Senegal - EGLNG Equatorial Guinea - ENI Congo - EXXON Angola, Cameroon,
Equatorial Guinea, Tchad - FOXTROT Ivory Coast - GEPSING Equatorial Guinea - ICS Senegal - MARATHON Equatorial Guinea - MAUREL & PROM
Gabon - MODEC Ghana, Ivory Coast - OPS Angola - PALMOR Cameroon - PERENCO Cameroon, Congo, DR Congo, Gabon PETROCI Ivory Coast
PUMA Ghana - SAIPEM Congo - SAR Senegal - SCCI Ivory Coast - SIPH Group - SIR Ivory Coast - SOGARA Gabon - SOMAIR Niger - SOMDIAA
Group - SONANGOL Angola - SONARA Cameroon - SPIE Congo, Gabon - STEVE MARCUS Nigeria - SUCRIVOIRE Ivory Coast - TAQA Ghana
TOR Ghana - TOTAL Angola, Congo, Gabon - TRIDENT Brazil, Equatorial Guinea - VOLTA RIVER AUTHORITY Ghana - YOKOGAWA Angola

& ENGINEERED PRODUCTS & SERVICES



Corinne DELAIRE
Managing Director
+33 (0)6 50 59 09 65
corinne.delaire@fr-eps.com



Sylvain PRIEUR
Sales Director
Condition Monitoring Specialist
+237 652 127 095
sylvain.prieur@fr-eps.com



Boris LICK
Sales Engineer
API 6A, Manual & Actuated Valves Specialist
+237 650 624 168
boris.lick@fr-eps.com



Gaylor LWAMBA
Sales Engineer
Aftermarket Specialist / Spare Part Manager
+237 677 048 856
Gaylor.lwamba@fr-eps.com



Stéphane DE SOUSA
Sales Manager
Safety Valves Specialist
+33 (0)7 65 75 71 65
stephane.desousa@fr-eps.com

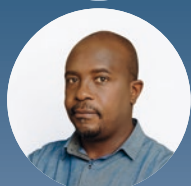

Mpumi DUBE
Technical & Sales Coordinator
Control and Choke Valves Specialist
+237 671 094 823
mpumi.dube@fr-eps.com



Chancelle ABESSOLO
Logistics & Sales Assistant
+ 237 654 548 309
chancelle.abessolo@fr-eps.com



Glen CROMACK
Technical Director
+44 7305 163977
glen.cromack@fr-eps.com



Fabien ILIK
Sales Assistant
+237 672 705 050
assistance.douala@fr-eps.com



Marie Sandrine BIKAA
Logistics & Sales Assistant
+ 237 675 876 907
marie-sandrine.bikaa@fr-eps.com



Olavo CILO
Angola Outside Sales Engineer
+244 930 957 255
olavo.cilo@fr-eps.com



Nathalie MARKSMAN
Logistics and Finance Director
+33 (0)7 61 29 37 43
nathalie.marksmann@fr-eps.com



Graphic design C.I.D. - www.cld.fr

Our locations

FRANCE Paris
ANGOLA Luanda
CAMEROON Douala
SENEGAL Dakar



ENGINEERED
PRODUCTS
& SERVICES

E.P.&S.

Your Valve Specialist in Africa

ventes@fr-eps.com
logistique@fr-eps.com
www.fr-eps.com